



## Table Of Contents

<b>Theater Pricing.....</b>	<b>1</b>
<b>Theater Technical Information .....</b>	<b>6</b>
<b>Seating Chart .....</b>	<b>16</b>
<b>Theater Stage Plot.....</b>	<b>17</b>
<b>Theater Lighting Plot .....</b>	<b>18</b>

# Theater Pricing

## Four Walls Rental Package

\$250 hr.

½ Day Rate \$1,000

Day Rate \$1,500

## Standard Rental Package

½ Day \$2,000

Day \$3,000

Weekly \$9,500

## Non-Profit Rates

½ Day \$1,600

Day \$2,600

Weekly \$8,000

## Included with all Rental

145 Seat Theater

ADA Compliant Ramp Entrance/Restrooms

Wheelchair Elevator access to Stage Level

Lobby area for Patrons Use Only

## Included in Four Walls Package *-(additional staff may be needed based on discussion with Theater)*

One General Stage Wash

One House Manager

No Sound

Some limited furniture upon request

## Included in Standard Theater Package- *(additional staff may be needed based on discussion with TD)*

## Spaces

Dressing Rooms #1 w/ monitors and Restroom (6 max)

*Main Floor at audience level. Located at end of hallway from theater.*

Dressing Room #2 w/ monitors (10 max)

*Located beneath stage on lower level. Stage access via stairs direct backstage to upstage right. Restrooms available in hallway on lower level*

Green Room (During tech/performances)

Box Office Set Up

## Standard Light Package

ETC ION Classic Console

Preset Looks based on House Rep Plot

*Look collection available: Cabaret, Reading, Recital, Lecture (ask TD for more details)*

No Specials

Cue limit max based on overall tech/design scope performance

### **Standard Sound Package**

Yamaha LS932 Channel Sound Board  
3 Floor Mics, 5 Overhead Ceiling Mic  
Up to (2) Wired Microphones w/ stands  
Up to (2) wireless handheld mics  
(4) House Speakers  
(2) Sub Woofers  
(2) On/backstage monitors  
Use of Q-Lab- Cue limit max based on overall tech/design scope performance  
(3) Stage Manager Stations Clear-com System (SR, SL, Booth)  
(6) Listen Inferred Hearing System

### **Furniture/Props**

Up to 14 basic chairs  
(3) Small Blocks, (2) Medium Blocks, (4) Step Blocks  
SR/SL Audience Level 2 Step Unit  
Up to 12 Music Stands  
(2) 6' Tables  
(2) 4' table  
Podium

### **Staff**

#### Pre-Event Staff

Theater Manager  
Technical Director  
Box Office Manager

#### Event Staff

(1) Technician (46 hours weekly)  
(1) House Manager (35 hours weekly)  
Up to (3) Theater Service Associates

### **Services**

Audience View Ticket System (\$100 additional set up charge for free events)  
Basic Refuse removal (Above basic charged at a rate of \$30/day)

## UPGRADES BEYOND STANDARD PACKAGE

### **Sound-** (Require Hiring House Technicians)

Wireless Microphones \$25/Day/Microphone

Wireless Lavaliers -\$25/Day/Microphone

Monitors-\$15/Day/Per Monitor

Live Music Set Up- \$75/Day/Per Instrument

Guitar/Bass Amp Rental- \$10 per day

Clear-com System:

Wired units (up to 3 more units) \$5/Day

Wireless units (up to 3 units) \$10/Day

### **Lighting**

Full Design Package Day Rate -\$450 1<sup>st</sup> Day \$175 each additional Day

**Includes:** access to entire rep plot plus 5 hrs. Master Lighting Tech

Full Design Package Weekly Rate \$1,250

**Includes:** access to entire rep plot plus 10 hrs. Master Lighting Technician

### **Projection**

Panasonic DP-DZ870U Projector Rental-\$175/Day or \$600/Week

Panasonic DP-DZ680UK Projector Rental-\$175/Day or \$600/Week

Short Throw lens available for an additional charge

Projection Designer-\$55 hour (5 hour minimum)

### **Live Music**

Yamaha Keyboard- \$75/Day

Baldwin Baby Grand Piano-\$125/Day

Upright Piano-\$100/Day

Piano Tuning-\$175/Tuning Session (Required)

### **Recording**

Silver Level Recording Package - Center Camera View Only - \$510 3 Camera View - \$640

Includes: Recording of 1 event

Staff- 4 hour Monitored recording of event

Recorded to 1TB Drive

Recordings include sound & Camera view

Gold Level Recording Package-Center Camera View - \$580 3 Camera View - \$710

Includes all in Silver Level package plus includes up to 10 Focal Changes

Platinum Level Recording Package- Center Camera View - \$690 3 Camera View - \$820

Includes all in Gold Level Package plus a 4-hour Rehearsal w/Cues

### **Flooring**

Marley - \$700 Set Up \$100.00 Daily Rental \$450 Weekly Rental

## STAFF/SPACE UPGRADES

### **Staff Rates (5 hour minimum)**

Technical Director: \$60/hour

Master Lighting Technician/Lighting Designer: \$55 hour

Master Sound Technician/Sound Designer: \$55/hour

Sound Board Operators: \$35/hour

Theater Technicians: \$35/hour

Box Office Manager: \$40/hour

House Manager: \$40/hour

Theater Service Associates: \$30/hour

### **Additional Spaces**

Green Room/Lobby Event Rental (any moving of furniture requires rental)

Non-Profit Rate- \$60/hour For Profit Rate-\$75/hour

Access to Westside YMCA Shower facilities is limited to Gym hours and only granted upon written request to Owner.

## **THE MARJORIE S. DEANE LITTLE THEATER**

	YMCA Spaces (40% discount w/ Theater Rental)	For Profit	Non-Profit
56'x42'	King Alfonso	\$295	\$260
23'x43'	Social Justice Lounge	\$245	\$210
27'x32'	Parkside Lounge	\$270	\$235
20'x32'	Fireside Lounge	\$220	\$205
22'x24'	2nd Floor Barre Dance Studio	\$235	\$210
18' x 30'	2nd Floor Activity Room 1or 2	\$235	\$210

## DEFENITIONS

Weekly is defined as up to 46 hours within a week of stager access up to 8 shows.

Day is defined as over 5 hours – 1- hours

½ Day is defined under 5 hours

Each full day rental requires one-hour total breaks for staff

### Cancellation Repayment Schedule

1. 61+ Day Cancellation 100% Refund (minus \$500 non-refundable deposit)
2. 31-60 Day Cancellation 75% Refund (minus \$500 non-refundable deposit)
3. 30+ Day Cancellation 50% Refund (minus \$500 non-refundable deposit)
4. Less than 30 Day Cancellation- No refund

### Payment Schedule

1. 1<sup>st</sup> Payment \$500 Non-Refundable Deposit on acceptance of Quote
2. 2<sup>nd</sup> Payment of 25% of Balance Due with signed Contract

Final Payment of Remaining Balance Due 30 Days prior to Event.

**THE MARJORIE S. DEANE  
LITTLE THEATER**



# Theater Technical Information

THEATER TECHNICAL PACKET
--------------------------

## **THEATER LOCATION:**

10 West 64th street, New York NY, 10023

ADA Complaint Ramp & Stair Access

## **Directions:**

**MTA** – 1, A, C, E, B, D trains to 59th street Columbus Circle. Walk NORTH to 10 West 64th street between Central Park West and Broadway.

**BOX OFFICE:** Located at 64th Street Entrance

**REST ROOMS:** Two ADA Compliant Audience Restrooms are located on theater level.

## **DRESSING ROOMS:**

**Dressing Room #1:** Main Floor at audience level. Located at the end of hallway from theater.

Restroom is in the dressing room. (Accommodates up to 6)

**Dressing Room #2:** Beneath stage on lower level. Stage access via stairs directly backstage to upstage right. (Accommodates up to 10)

Restroom available around the corner with additional dressing space and mirrors.

## **HOUSE AND SEATING:**

Capacity: 145 Seats including ADA accessible seating

132 Seats (Row A Removed)

118 Seats (Rows A and B Removed)

Two aisles - house right and house left (entrance in rows A-D Only)

Rows A-C Single Level Seating, Rows D-K Multi Level Seating

### **LOADING ENTRANCE:**

Loading door #1: 6'-8" tall by 3'-5" wide, 64th Street small ramp (access to theater via hallway)

Loading door #2: 6'-8" tall by 3'-4 1/2" wide: NOTE: House Left Vom is only 2'-10" wide,

64th Street with 3 steps from ground level (Direct access to rear of house left)

\*\*Ramps or forklift not provided

### **STAGE INFORMATION:**

The stage floor is tongue and groove pine with a Masonite overlay. Stage is plus 2'-8" from theater floor, ACCESSIBLE VIA STAIRS ONLY.

#### **Stage Access:**

1. Downstage Right exits via four stairs to door in House.
2. Upstage Right staircase down to lower-level dressing room under stage.
3. Upstage Left 4 stairs to hall Exit.
4. Upstage Left ADA Lift to hall Exit.

#### **Dimensions:**

- Arched Proscenium height 11'-9 1/2" at CL, 9'-8 1/2" at Proscenium
- Proscenium width 20'-1"
- Depth of stage at Center Line 24'-1/4"
- Back wall to plaster line 18'-5 1/2"
- Plaster line to Stage thrust 5'-6 3/4"
- Stage width (SL to SR walls) 42'-1"
- Stage Left wing space 10'5" (Note some permanent racks in place)
- Stage Right wing space 11'-4" (Grand Piano stored on this side)
- Upstage of Cyclorama crossover 4'-2"



## **SOFT GOODS INVENTORY:**

### **Main Drape:**

Colonial brick velour: two pieces 14' wide x 12'-6" high

### **Legs, Borders & Travelers:**

All Black Charisma Velour

SL Leg #1: Leg #2 - 4' w x 13'-7" H                      &                      Leg #3 - 4'-6" w x 13'-6" H

SR Leg #1: Leg #3 - 4'-6" w x 13'-6" H                      &                      Leg #2 - 4' w x 13'-7" H

MidStage Traveler: 13' w x 12'-6" h

SL Leg #2: sl Traveler Tab - 3' w x 13'-10" H &                      sr Traveler Tab - 3' w x 13'-10" H

SR Leg #2: Tab #1 - 4' w x 13'-6" H                      &                      Tab #3 - 4' w x 13'-6" H

UpStage Traveler: 13' w x 12'-6" h

Borders #1 & #2 - 24' w x 3'-6" h                      Border #3 - 24' w x 4'-6" h

Traveler Border 13'-10" w x 3' h

### **Cyclorama:**

White muslin, seamless, bottom pipe pocket, 24' w x 13'-6" high.

### **Projection Screen:**

13'-8" w x 7'-8" h (projection area – pipe #5)

**GRID:** (See Line Set Schedule)

Line Set #1 is Main House Curtain

Total 16 Line Sets available (dead hung pipes only) 750 lbs Total weight capacity.

Baton length 25', schedule 40 pipe. Trim height from deck varies, Minimum +13'-6"

Pipe #	Distance from PL	Description
1	11 1/2"	House Curtain
2	1'-1"	Empty
3	2'	1 <sup>st</sup> Electric
4	3'-3 1/4"	SL & SR Legs
5	3'-8"	Projector Screen
6	4'-5 1/2"	Empty
7	5'-5 3/4"	Empty
8	5'-11 1/4"	Traveler
9	6'-10 1/2"	2 <sup>nd</sup> Electric & Projector
10	8'-3 1/2"	2a Electric & Work lights
11	9'-2 3/4"	Empty
12	10'-3"	Empty
13	11'	SL & SR Legs w/tabs
14	11'-11 1/4"	3 <sup>rd</sup> Electric
15	12'-11 1/4"	Black Traveler
16	13'-7 3/4"	4 <sup>th</sup> Electric - Cyc Lights
17	14'-3"	Cyclorama

## **LIGHTING SYSTEM:**

### **Control Board:**

ETC ION Classic Console w/ Fader Wing and Touch Screens (2)

### **Dimmers:**

Sensor+ Dimming system SR48+ 800 amp, 120/208 VAC; 3-phase, 4-wire 50/60Hz

### **Houselights:**

Control located stage left & in control booth. (DMX Control via console available)

### **Circuits:**

78 3-stage pin 2.4 kw circuits, 2 4-circuit wall pockets SL and SR.

## **LIGHTING EQUIPMENT INVENTORY:**

# THE MARJORIE S. DEANE LITTLE THEATER



### **REP PLOT EQUIPMENT**

### **Conventional:**

10 - 50-degree Source Four Dimmer Doubled 120v/750w

18 - 36-degree Source Four Dimmer Doubled 120v/750w

15 - 50-degree Source Four 120v/750w

6 - 36-degree Source Four 120v/750w

**Intelligent / LED Fixtures:**

- 20 - Martin RUSH Par 2 Zoom (LED)
- 4 - Martin RUSH MH 2 Wash (Moving Head LED)
- 5 - Martin RUSH MH 7 Hybrid (Fully Intelligent Spot Fixture)
- 10 - Chroma Q Color Force 12
- 3 - Chroma Q Color Force 72
- 3 - 50-degree LUSTER Source Four 171w

**FIXTURES NOT IN THE REP PLOT**

\*\*\*Use of non-rep fixtures is at the discretion of theatre management

**Intelligent / LED Fixtures:**

- 4 - Martin RUSH MH 1 Profile 300w (Moving Head LED)
- 4 - Martin RUSH MH 2 Wash 125w (Moving Head LED)
- 2 - Martin RUSH MH 7 Hybrid 420w (Fully Intelligent Spot Fixture)
- 7 - Martin MAC 550 Profile 400w (Moving Light Fixture)
- 7 - Slim Par 64 Spotlights

**Conventional:**

- 10 - 6" Fresnels 120v/500w
- 3 - MR-16 Birdies
- 4 - 50-degree Source Four 120v/750w
- 1 - 36-degree Source Four Barrel

**Cable:**

Assorted Edison, Stage-Pin, DMX Cable

**Accessories:**

\*\*\*Use of accessories is at the discretion of theatre management

- 2 - Gam Film-FX w/ assorted loops
- 2 - Gobo Rotators

## **FILM, VIDEO & PROJECTOR EQUIPMENT:**

1 Panasonic PT-DZ870UK / 8,500 Lumens DLP Projector

1 Panasonic PT-DZ680 / 6,000 Lumens DLP Projector

1 Mac Mini - Monterey version 12.6.5

Video/Audio Playback System Available

QLab 4.7 Rental Licenses Available

1 Blackmagic Design ATEM Mini Extreme ISO

1 FoMaKo PTZ Camera Controller with 4D Joystick

3 FoMaKo PTZ Camera HDMI 30x Optical Zoom

## **SOUND EQUIPMENT INVENTORY:**

### **Console:**

1 Yamaha LS9 32 channel console (with MY 16-AT I/O Card Installed)

### **Loudspeaker Cabinets:**

4 - JBL-VRX - 932LA

2 - JBL-VRX - 918s subs

5 - JBL-PRX - 412m (monitor wedges)

1 - Crown I - T6002 (for FOH) - AMP on Stage

2 - Crown XLS802 (for Monitors) - AMP on Stage

1 - QSC GXD8 (for Subs) - AMP in Booth

### **Microphones:**

5 - SM58 Dynamic microphone

2 - SM57 Dynamic microphone

5 - MX202 Supercardioid Overhead microphones (5-Black)

3 - Crown PCC 160

2 - Sennheiser Shotgun ME66

## FIXTURES NOT IN THE REP PLOT

\*\*\*Use of non-rep fixtures is at the discretion of theatre management

### Microphones:

- 1 - Audix Drum Mic Kit (missing 1 F15 mic)
- 1 - E835S Sennheiser (with on/off switch)
- 1 - E835S Sennheiser (with-out on/off switch)
- 1 - Audio-Technica AT815b
- 2 - MX202 Supercardioid Overhead microphones (White)

### Wireless:

- 12 - SLX4 Wireless Diversity Receiver
- 10 - SLX2/SM58 Wireless microphone
- 12 - SLX1 Bodypack Transmitter
- 11 - WL 185 cardioid Mic (Lapel mic)
- 12 - Countryman B3 9-Beige, 4-Black (Lavalier mic)
- 3 – Sure 92 Black (Lavalier mic)

### Accessories:

\*\*\*Use of accessories is at the discretion of theatre management

Mic Stands, cables, adapters, etc...



## COMMUNICATIONS SYSTEMS:

### COMMUNICATION SYSTEM:

Clear-Com Headset System with six (6) operating positions

1 - Clear-Com MS-702 Master Station (located in AV Rack in booth)

5 - Clear-Com RS-701 Belt pack with Headset

3 - Clear-Com Wireless Belt BP 410 with Headset and battery

### STORAGE & SHOP:

Limited storage in wings

Shop Area: none



**THE MARJORIE S. DEANE  
LITTLE THEATER**



LOADING DOOR  
STREET ACCESS  
NO RAMP

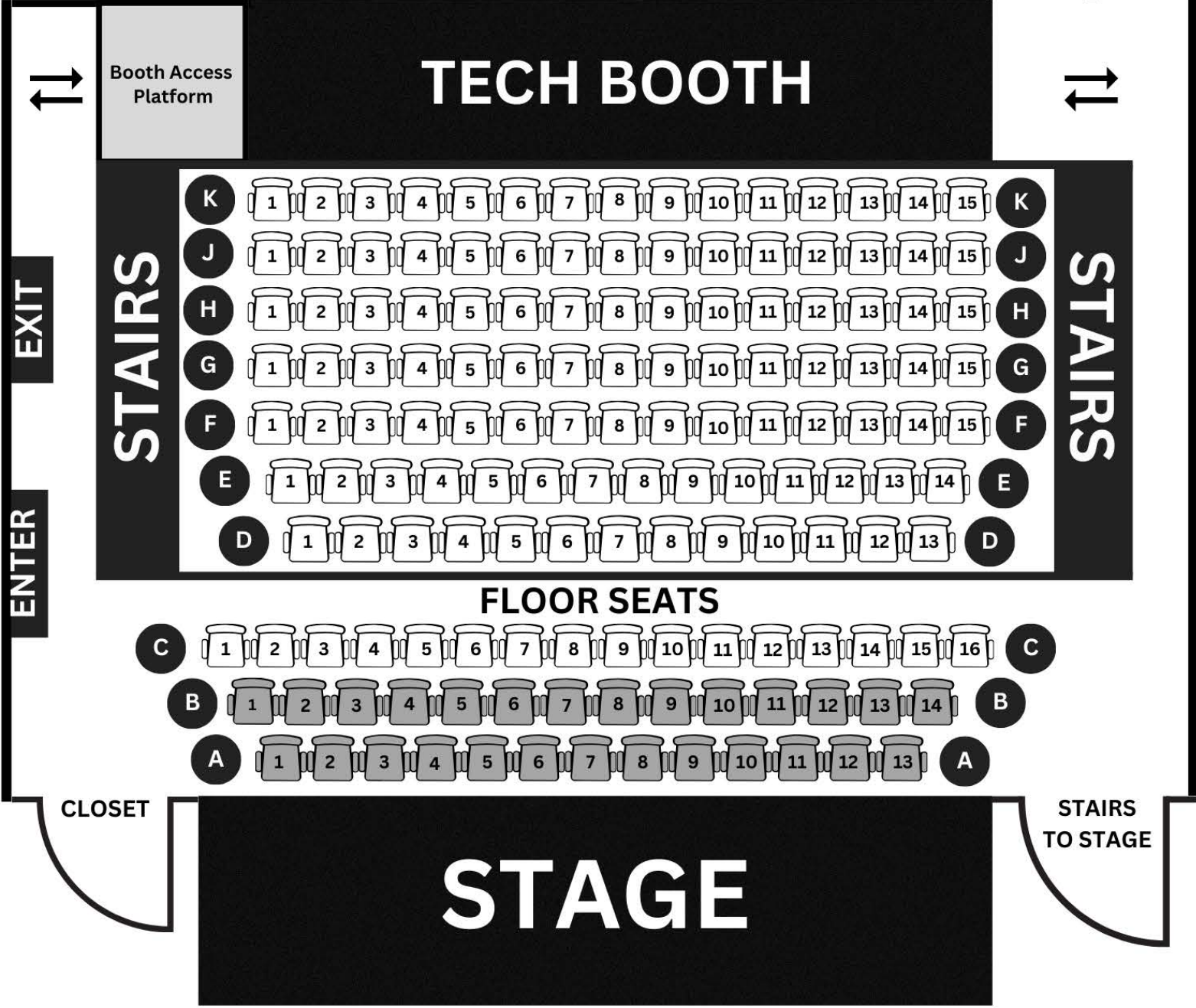

**Removable Seats**

**Fixed Seats 118  
Removable Seats 27  
Total Seats 145**



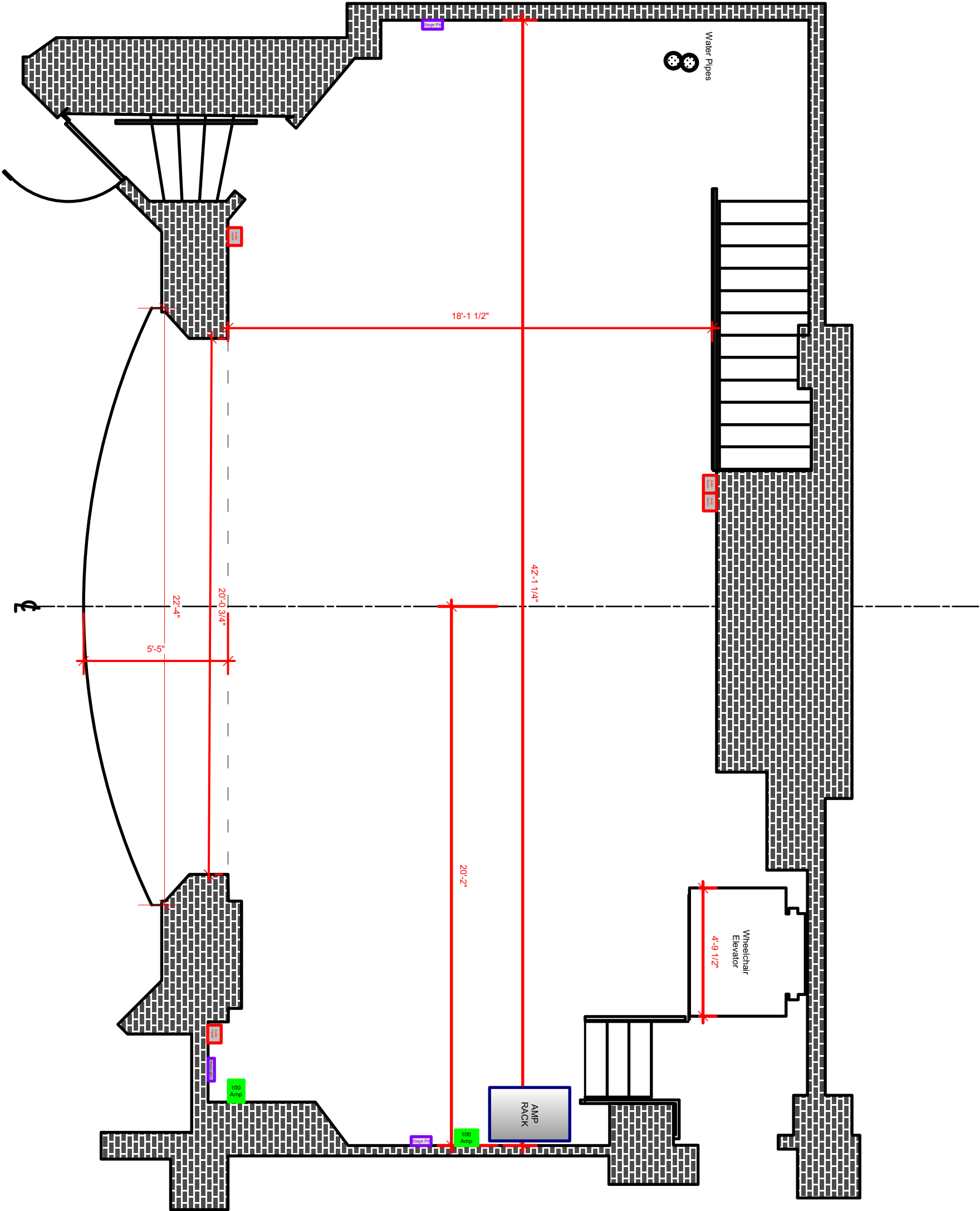

Title		
Marjorie S. Deane Little Theater		
Sheet Title		
GROUNDPLAN		Scale: 1/4" = 1'

